



## Westminster Green 8 Dean Ryle Street

, London, SW1P 4DA

£3,033 Per month



We are pleased to offer this extremely bright one bedroom apartment available for rent in this very sought after development close to the banks of the River Thames. The property has recently been redecorated throughout and is sold with vacant possession.

Residents of Westminster Green benefit from a 24 hour concierge, lavish lobby area, business suite and a gymnasium. You will be within walking distance to the amenities of Horseferry Road and Victoria Street which include many shops, a Curzon Cinema and a host of new restaurants. The development is also located next door to the international headquarters of Burberry and the Westminster Hotel. The transport links of St James's Park, Westminster and Victoria are all within walking distance.



# Area Map



# Floor Plans

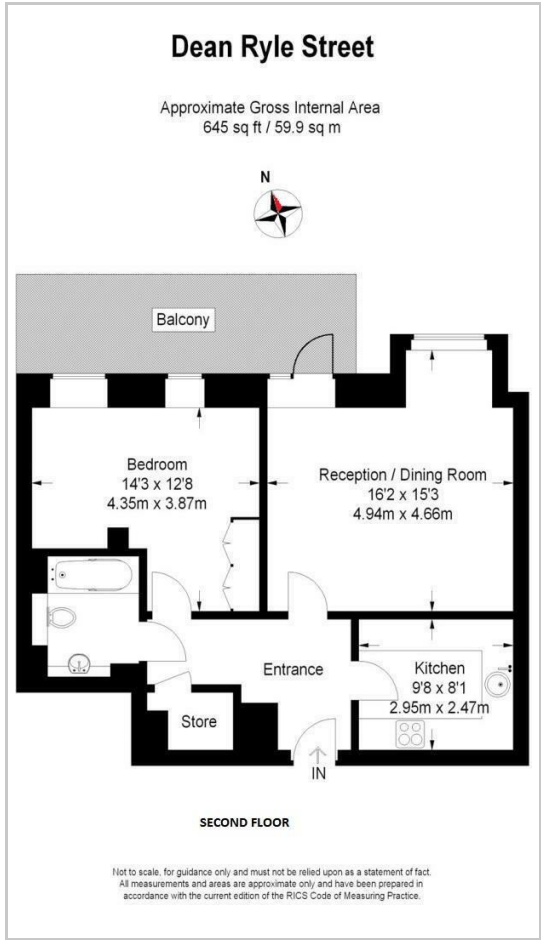

# Energy Efficiency Graph



These particulars, whilst believed to be accurate are set out as a general outline only for guidance and do not constitute any part of an offer or contract. Intending purchasers should not rely on them as statements of representation of fact, but must satisfy themselves by inspection or otherwise as to their accuracy. No person in this firm's employment has the authority to make or give any representation or warranty in respect of the property.